

PRODUCT SPECIFICATIONS

Dimensions:	135mm x 165mm x 295mm (5.3" x 6.5" x 11.6")	Temperature Control	Settings of 1 – 4 Heater Plate Temperature operating maximum of 65°C
Weight:	2.5kg (5 lbs)	Performance	Delivered pressure: 3-18cmH ₂ O Max. delivered gas temperature: 32°C Delivered Humidity: 0-26mg/L Warm-up time: 10-20 minutes.
Electrical Ratings		Standards Compliance	Designed to conform to the requirements of: IEC 60601-1 UL1431 CSA C22.2/No. 68 AS3200.1.0 EN60601-1
Supply Frequency:	50-60 Hz		
Supply Voltage and Current:	230V, 0.8A max (at 220-240V) 115V, 1.6A max (at 115V) 100V, 1.7A max (at 100V)		
Suitable for use with a DC to AC inverter:	200W minimum		
Heater Plate:	85W		

TROUBLESHOOTING

In the unlikely event that you tip water into the blower outlet:

- Remove air filter and chamber
- Shake excess water out of the back of the unit
- Turn unit on and run at prescribed pressure for 5 minutes
- Re-assemble and use as directed

If you feel that your HC200 is not operating correctly, consult your homecare dealer. Do not attempt to repair the HC200 yourself.

The amount of time required to go from 3 cm to prescription pressure is affected by the following variables:

- A) Heater plate temperature. When the unit is first turned on, the temperature of the heater plate is measured.
- B) Set temperature. When the unit is first turned on, the temperature selected by the temperature control knob is recorded.
- C) Prescription pressure. The pressure set by your clinician is noted by the HC200 unit as the target pressure.

When the unit is turned on, the actual temperature of the heater plate is compared with the target temperature set on the temperature control knob. The HC200 series unit calculates how long it will take to heat 400 ml of water from the heater plate temperature to the target temperature. The pressure is then increased from 3 cm to prescription pressure at the same rate that the water heats up. The amount of time that it takes to go from 3 cm to prescription pressure will vary depending on the temperature selected, the starting (heater plate) temperature, and the amount of water in the chamber. For most applications it takes anywhere from 15 to 25 minutes to get to full pressure. Unusual applications can significantly increase or decrease this time.

READ ALL INSTRUCTIONS BEFORE USE



Fisher & Paykel
HEALTHCARE

HC200 SERIES HUMIDIFIED CPAP SYSTEM

The HC200 series humidified CPAP system provides the user with an integrated CPAP and heated humidifier for use in the home.

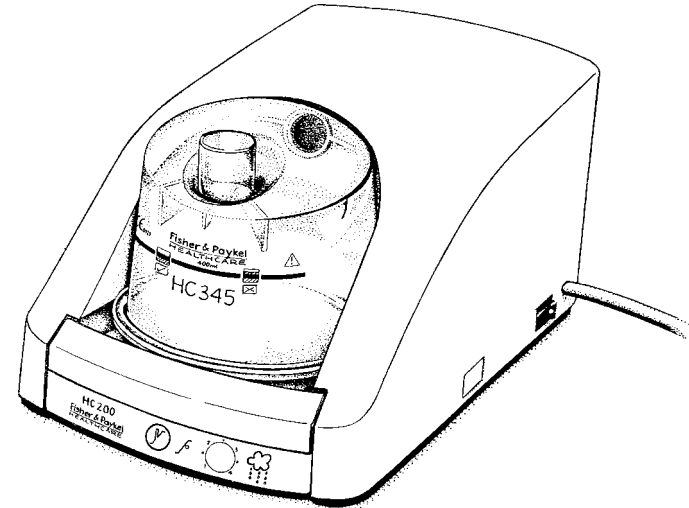

Part Number : 185042118 Rev B

Patents Pending in Principal Countries of the World

INSTRUCTION SHEET - DO NOT DISCARD

International: PO Box 14-348, Panmure, Auckland 6, New Zealand Email: info@fphcare.com Web Site: www.fphcare.com
Tel: +64-9-574-0100 Fax: +64-9-574-0158

USA: Suite 101, 22982 Alcalde Drive, Laguna Hills, California 92653, USA Tel: +949-470-3900 Fax: +949-470-3933 Toll Free: +1-800-446-3908

Australia: 36-40 New Street, Ringwood, Victoria 3134, Australia, Tel: +61-3-9879-5022 Fax: +61-3-9879-5232

*UK and Ireland: Unit 16, Cordwallis Park, Clivemont Road, Maidenhead, SL6 7BU, United Kingdom Tel: +44-1628-626-136 Fax: +44-1628-626-146

France/Benelux: 10 Avenue du Quebec, SILIC S12 - Villebon, 91946, COURTABOEUF CEDEX, France Tel: +33-164-46-5201 Fax: +33-164-46-5221

Germany/Austria Tel: +49-(0)7182-93777-0 Fax: +49-(0)7182-93777-99

CE 0123

*European Authorised Representative

CONTENTS

<i>Symbol Definitions</i>	3
<i>Important Safeguards</i>	3
<i>Cleaning & Maintenance</i>	4
<i>Grounding Instructions</i>	4
<i>Package Contents</i>	5
<i>Important Parts of Your HC200 Series System</i>	5
<i>Getting Started</i>	6
<i>Making the Most of Your HC200 Series</i>	9
<i>Using Your HC200 Series with Heated Humidification</i>	9
<i>Using Your HC200 Series without Heated Humidification</i>	10
<i>Frequently Asked Questions</i>	11
<i>Product Specifications</i>	12
<i>Troubleshooting</i>	12

FREQUENTLY ASKED QUESTIONS

When I wake up in the morning, my nose and throat feel dry. What can I do?

Try increasing the setting on your humidity control. If this does not work, please contact your clinician for advice.

How do I prevent condensation in the tubing?

The humidity control enables adjustment of humidity, so that there should be fine misting in the six inches of the breathing tube closest to your face. If the humidity control is set too high for the conditions, condensation may occur in the breathing tube. Note: Using greater than 6' (183 cm) of tubing will increase condensation

There are several ways of reducing condensation in the tube:

1. Ensure the HC200 is not positioned in a cool draft.
2. Insulate the tubing by positioning it under the bedcovers, by using the 900HC003 rainout reduction kit, wrapping it with flexible bubble wrap, cut the toes out of tube socks and bunch them around the tubing.
3. Warm the air in the room.
4. Turn the temperature control on your HC200 series down slightly. Gradually decrease the setting until the condensation no longer occurs.

Do I have to use distilled water with my HC200?

The use of distilled water will maximize the life of the HC345 water chamber. Water from the faucet will often contain minerals which can damage the chamber, causing pitting in the base, even if the water is passed through a filter.

Can I use my HC200 in other countries?

Yes. Simply use the appropriate electrical socket adaptor and the HC200 will automatically adapt to any voltage supply. Note: When moving your HC200, ensure that the water chamber is empty. Machine failure due to water damage is not covered by warranty.

How do I replace the air filter?

Remove the filter from the holder as shown:

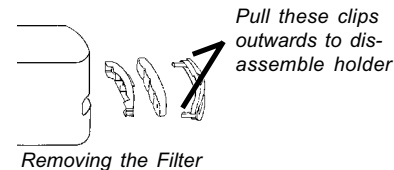

Note: When inserting the new filter, ensure that the black dot is facing towards the machine.

Can I use Oxygen with my HC200?

Yes, oxygen can be administered at the mask. Ensure that the oxygen source is turned off before turning off the HC200 to avoid oxygen accumulating in the machine.

When do I replace my HC345 humidification chamber?

Replace the chamber if the plastic walls of the chamber become cracked or cloudy or the chamber base becomes pitted. (Note: If the chamber leaks at all, it should be replaced immediately)

USING YOUR HC200 SERIES WITHOUT HEATED HUMIDIFICATION

Occasionally, some users prefer not to use heated humidification. Heated humidity can be disabled by setting the humidity control to the 'off' region.

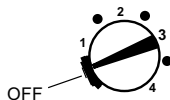

1. When the HC200 series is switched on (with the humidity control in the 'off' position), it will **automatically go to your prescribed pressure** (the green warm-up light will be **off**).

If you want to activate warm-up mode, simply press the warm-up button on the front of the unit. The HC200 series will increase from minimum pressure to your set pressure over approximately 15 minutes.



WARM-UP
BUTTON



WARM-UP
LIGHT

2. Re-entering warm-up mode during the night:



If you get up during the night, turn off the HC200 at the power switch.

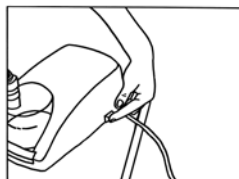

Wait for 3 seconds. Turn the HC200 series back on, then press the warm-up button.

When you return to bed, the HC200 series will be in warm-up mode (which lasts for up to 15 minutes). This will allow you to fall asleep as the HC200 series gradually increases the pressure to your personal settings.

SYMBOL DEFINITIONS



Type B



ATTENTION
Consult
accompanying
documents



Alternating
Current



Drip Proof



CE Mark
93/42/EEC
Class IIb

IMPORTANT SAFEGUARDS

US Federal law restricts this device to sale by or on the order of a physician. The HC200 should only be used on prescription from a licensed physician.

DANGER - To reduce the risk of electrocution:

- Always disconnect the HC200 immediately after using.
- Do not use the HC200 while bathing.
- Do not store the HC200 where it can fall or be pulled into water.
- Do not place or drop the HC200 into water or other liquid.
- Do not reach for an HC200 that has fallen into the water. Unplug immediately.

WARNING - To reduce the risk of burns, electrocution, fire or injury:

- Do not touch the heater plate. The heater plate temperature may exceed 65°C (149°F)
- The HC200 should not be left unattended when plugged in.
- Close supervision is necessary if the HC200 is used by, on, or near children or invalids.
- Use the HC200 only for its intended use as described in this manual. Use only Fisher & Paykel recommended accessories with the HC200.
- Never operate the HC200 if it has a damaged power cord or plug, it is not working properly, if it has been dropped or damaged, or any part of the HC200 has been dropped into water. Return the HC200 to an authorised service center for examination and repair.
- Keep the power cord away from heated surfaces.
- Never block the air openings of the HC200 or place it on a soft surface such as a bed or couch, where the openings may be blocked. Keep the air openings free of lint, hair or the like.
- Never drop or insert any object into any opening or tube.
- Do not use outdoors or operate where aerosol (spray) products are being used.
- Connect the HC200 to a properly grounded outlet only. See Grounding Instructions.
- **Remove humidification chamber before filling, and fill humidification chamber with distilled water only.** See Getting Started.
- At low CPAP pressures, the flow through the mask may be insufficient to clear all exhaled gas from the tubing, and consequently some rebreathing may occur.
- Adjusting the pressure control can result in ineffective therapy. The pressure control must only be adjusted by the clinician.
- The HC200 should only be used with masks and connectors recommended by Fisher & Paykel Healthcare, or by your physician or respiratory therapist. A mask should not be used unless the HC200 is switched on, and operating properly. The vent hole(s) associated with the mask should never be blocked.

CAUTION - Do not use your HC200 in close proximity to high frequency apparatus, shortwave or microwave equipment. Emissions from such devices may effect the HC200's operation.
- Do not block air flow from the HC200.

OXYGEN USE

If supplemental oxygen is used with the HC200, the oxygen flow must be turned off when the HC200 is not operating. This ensures that oxygen will not flow through the tube and accumulate in the HC200 enclosure.

- The HC200 should be located in a position where ventilation around the device is not restricted.
- It is recommended that supplemental oxygen be administered at the mask.
- Oxygen should not be used while smoking or in the presence of an open flame.
- The use of oxygen in therapy requires that special care be taken to reduce the risk of fire. Any materials which will burn in air and some that will not are easily ignited and burn rapidly in high concentrations of oxygen. Accordingly, for safety it is necessary that all sources of ignition be kept away from the product and preferably out of the room in which it is being used. "NO SMOKING" signs should be prominently displayed.
- A spontaneous and violent ignition may occur if oil, grease or greasy substances come in contact with oxygen under pressure. These substances must be kept away from oxygen regulators, cylinder valves, tubing and connections, and all other oxygen equipment.

CLEANING & MAINTENANCE

NOTE: The HC200 should be cleaned as required.

1. Switch off the HC200 and unplug from the power socket.
2. Wipe the exterior of the HC200 with a clean, damp (not wet) cloth and mild dishwashing detergent. Note: do not use harsh abrasives or solvents, or these will damage the HC200.
3. Daily - Rinse the water chamber and breathing tube with warm, soapy water.
4. Weekly - Soak the inside of the chamber for 10 minutes in a solution of one part white vinegar to ten parts water.
5. Replace the air filter when it becomes significantly discolored.

WARNING

- * Refer all other maintenance to qualified service personnel.
- * Always switch off the HC200 and unplug the power cord from the power socket before cleaning.
- * Never rinse or place the unit in water or allow water to get into the interior of the unit.
- * Ensure that the unit is dry before plugging into the power socket.

GROUNDING INSTRUCTIONS

The HC200 should be grounded. In the event of an electrical short circuit, grounding reduces the risk of electric shock by providing an escape wire for the electric current. The HC200 is equipped with a cord having a grounding wire with a grounding plug. The plug must be plugged into an outlet that is properly installed and grounded.

DANGER - Improper use of the grounding plug can result in a risk of electric shock.

Check with a qualified electrician or serviceman if the grounding instructions are not completely understood, or if in doubt as to whether the HC200 is properly grounded.

Extension Cords:

If it is necessary to use an extension cord, use only a 3-wire extension cord that has a three-blade grounding plug, and a 3-slot receptacle that fits the HC200 plug. Replace or repair a damaged cord.

In Canada/USA only:

This product is for use on a nominal 120V circuit, and has a grounding plug that looks like the plug illustrated (Figure 1). A temporary adaptor, may be used to connect this plug to a 2-pole receptacle if a properly grounded outlet is not available. The temporary adaptor should be used only until a properly grounded outlet (Figure 1) can be installed by a qualified electrician. The green coloured rigid ear, lug, etc extending from the adaptor, must be connected to a permanent ground such as a properly grounded outlet box cover. Whenever the adaptor is used, it must be held in place by the screw.

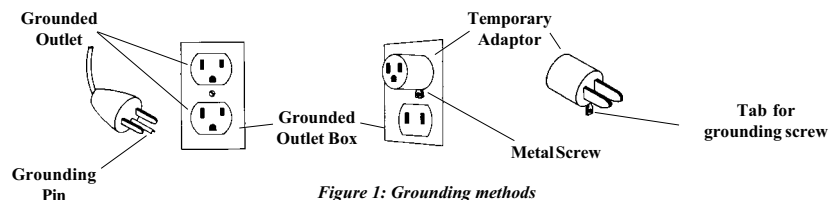

Figure 1: Grounding methods

If repair or replacement of the cord or plug is necessary, do not connect the grounding wire to either flat blade terminal. The wire with insulation having an outer surface that is green with or without yellow stripes is the grounding wire.

MAKING THE MOST OF YOUR HC200 SERIES

Many users, when first using CPAP therapy, find the airflow uncomfortable. To help you fall asleep comfortably, the HC200 series provides a gradual increase in pressure and humidity if required. We call this feature warm-up. Warm-up can be used with or without heated humidification. To use warm-up, follow these simple steps:

USING YOUR HC200 SERIES WITH HEATED HUMIDIFICATION

1. When the HC200 series is switched on (See 'Getting Started'), it will **automatically enter warm-up** (the green warm-up light will be **on**). Warm-up will last for up to 20 minutes depending on machine settings, room temperature and water temperature (Note: see 'Troubleshooting' to read more about warm-up time).

If you want to go straight to your prescribed pressure, simply disable the warm-up cycle by pressing the warm-up button on the front of the unit (the green warm-up light will turn off).



2. Re-entering warm-up mode during the night:



If you get up during the night, turn off the HC200 at the power switch.

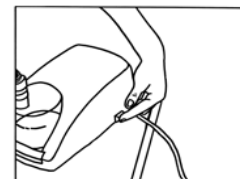

Wait for 3 seconds. Turn the HC200 series back on, then press the warm-up button.

When you return to bed, the HC200 series will be in warm-up mode (which lasts for up to 15 minutes). This will allow you to fall asleep as the HC200 series gradually increases the pressure and humidity to your personal settings.

12. Switch on the HC200 by pressing the power switch on the right hand side.

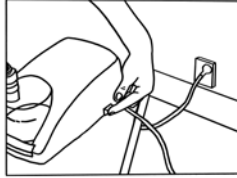

The HC200 is now ready for use.

PACKAGE CONTENTS

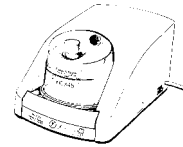

1 x HC201
(with hour meter)
or
HC200
(without hour meter)



1 x spare water chamber



1 x tube



1 x spare air filter



1 x water funnel

IMPORTANT PARTS OF YOUR HC200 SERIES SYSTEM



HEATER
PLATE
OFF

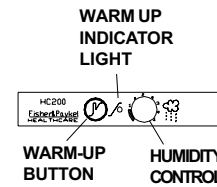

WARM UP
INDICATOR
LIGHT
WARM-UP
BUTTON
HUMIDITY
CONTROL

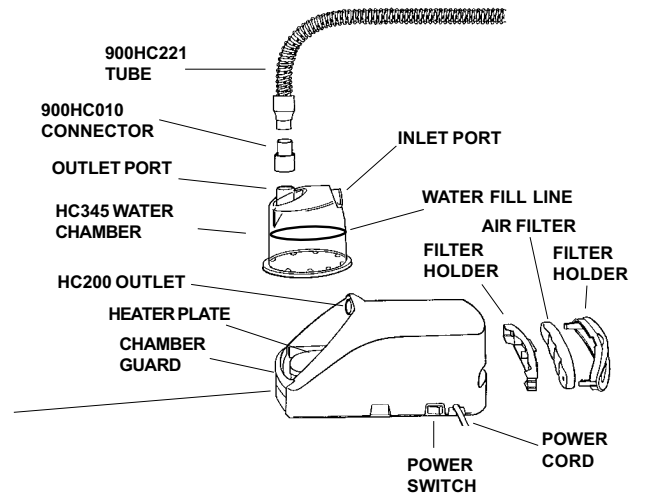

GETTING STARTED

1. Remove your HC200 from its packaging.
2. Place the HC200 on a low shelf or on the floor beside your bed. **Warning:** Ensure that the HC200 is placed at a level lower than head height while sleeping.
3. Remove one water chamber from the packaging.

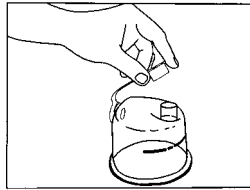

4. Remove the blue caps and discard.
5. Using the funnel provided, fill the water chamber up to the

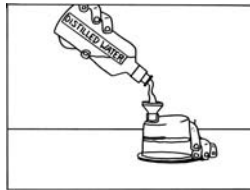

black line with distilled water.

6. To attach the water chamber to the HC200, press down the finger guard and slide the chamber on.

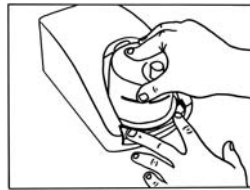

7. When the chamber is fitted correctly, the finger guard will click into place.



8. One end of the tube has a white plastic connector. Push this onto the outlet on top of the chamber.

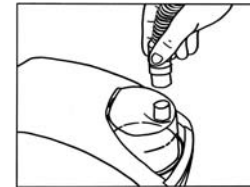

9. Connect the other end of the tube to the mask.
10. Plug the HC200 power cord into your household power socket.

11. Set the humidity control on the front of the HC200 series to '2' (or as recommended by your homecare dealer or sleep lab). If no heat is required, set the control to the shaded area.

